

## WHOLE BLOOD COLLECTION INSTRUCTION

DNA Research Centre offers a “**WHOLE BLOOD COLLECTION SET**” which is especially designed for collection and safe transportation of samples for genetic testing. Samples can be collected **only by qualified medical staff**.

### Contents of the set:

- Sealed blood collection set S-Monovette – 1 piece
- Disinfection gauze – 1 piece
- 2 latex gloves
- Foamed PS protective box – 1 piece
- Cooling insert - 3 pieces
- Self-addressed envelope (bubble) – 1 piece
- Whole blood collection instruction – 1 piece
- Genetic test submission form – 1 piece
- Diagnostic test price list – 1 piece



### I. Actions before blood collection:

- Cooling inserts should be kept in freezer **at least for 6 hours** before blood collection. Frozen cooling inserts allow to keep proper temperature of blood during transport.
- There is no need for any kind of special preparation by patient.

### II. Actions during blood collection:

**Notice!** All actions listed below must be performed only in latex gloves.

1. Disinfect properly area of puncture.



2. Connect syringe with needle.

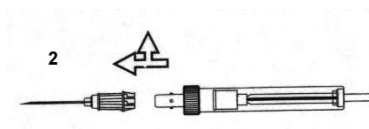

3. Insert needle into vein and collect blood sample.

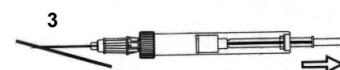

4. Move piston until a characteristic sound of full syringe will be heard, disconnect needle and break off piston.

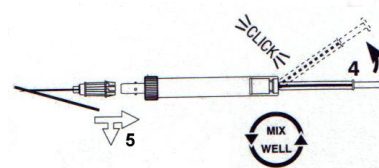

5. If a sufficient amount of blood was collected remove needle and mix well the content of probe.

If there will be a need of collecting bigger amount of blood after first collection please:

6. Prepare second syringe by pulling back piston until a characteristic sound can be heard and break off the piston.
7. Connect second probe with needle (still in vein), collect blood.

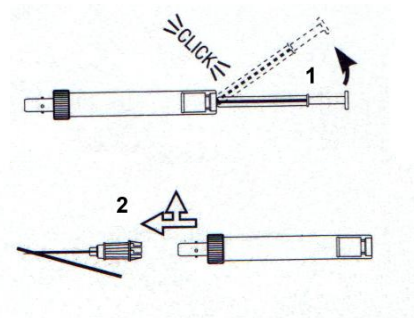

8. Disconnect needle and remove it from vein, mix content well.

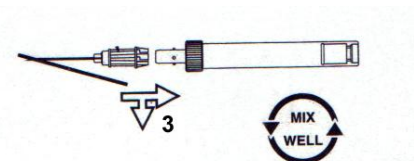

9. Describe probe with full name and surname of patient and date of collection. Sample must be always transported in a proper protective container with cooling inserts or in any container which would guarantee inner temperature of 4 - 10°C.
10. It is possible to store samples in refrigerator (temp. 4 - 6°C) up to 36 hours before sending. **Cooling inserts must be frozen before sending.**

**Notice! Blood cannot be frozen.**

11. Fill in the „ **Genetic test submission form - Hepatitis and Systemic infections diagnostic**“:
  - a. provide all personal data necessary for sample acceptance, including address and contact to tutor if patient is not an adult,
  - b. pick requested tests by marking appropriate boxes (please familiarize yourself with attached price list)

**Notice: signature of patient (or tutor) is necessary for accepting the sample**

12. Effectuate payment for tests according to the price list. Payment can be done in any post office or bank branch. We honor prints confirming transfer via internet – prints can be send by post, fax or e-mail.
13. Described and secured (in test tube with transportation medium) sample along with filled “Genetic test submission form” and copy of payment confirmation should be placed in provided self-addressed envelopes and send to DNA Research Centre.

### III. Sending samples:

Collected material should be send on following address:

**NZOZ Laboratorium Genetyki Medycznej, Centrum Badań DNA, ul. Mickiewicza 31, 60-835 Poznań**

**Packages should be send Monday to Thursday.**

**A sample of blood must be delivered within 36 hours, no later than Friday**

**IV. Payment details:**

Name: **Centrum Badan DNA**  
Address: **ul. Rubiez 46**  
Zip code: **61-612**  
City: **Poznan**  
Country: **POLAND**  
Bank: **ALIOR Bank S.A.**  
Account No: **payment in EUR: PL 95 2490 0005 0000 4600 7845 2801**  
SWIFT: **ALBPPLPW**

*In case you have any questions, please do not hesitate to contact us directly on:  
[bok@cbdna.pl](mailto:bok@cbdna.pl)*